



# HID-Basic ballasts for HPL and HPI(PLUS) lamps

## BHL 400L 200

The HID-Basic ballast is an impregnated (HID standard) electromagnetic ballast for HID lamps, for use in combination with an external ignitor.

### Product data

General Information		Temperature	
Application code	L200	T-winding (max.)	130 °C
		Delta-T normal conditions	70 °C
Operating and Electrical		Approval and Application	
Input Voltage	220 V	Approval marks	CE marking CCC certificate
Input frequency	50 Hz		
Power factor 100% load (min.)	0.85	Product Data	
Mains voltage performance (AC)	-8%~+6%	Full product code	697480505001700
Mains voltage safety (AC)	-10%~+10%	Order product name	BHL 400L 200
Input current with PF correction	2.15 A	EAN/UPC – product	6974805050017
Input current without PF Correction	3.25 A	Order code	913710100542
Power factor without PF compensation (nom.)	0.60	SAP numerator – quantity per pack	1
Power losses (nom.)	21.8 W	Numerator – packs per outer box	6
		SAP material	913710100542
Wiring		SAP net weight (piece)	2.780 kg
Connector type	Screw		
System characteristics			
Rated ballast-lamp power	400 W		

## HID-Basic ballasts for HPL and HPI(PLUS) lamps

### Dimensional drawing

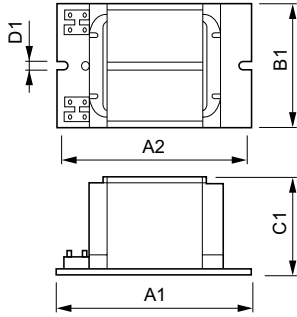

Product	D1	C1	A1	A2	B1
BHL 400L 200	6.2 mm	64.5 mm	150.0 mm	135.0 mm	75.5 mm

BHL 400L 200

