



GreenPerform Highbay G4

BY698P LED265/NW PSD NB GM G2

GreenPerform Highbay G4 - 840 neutral white - Power supply unit - Beam angle 60°

Following the success of the GreenPerform Highbay families, the GreenPerform Highbay G4 is continuously exploring a better price and performance balance. The product family offers wide product ranges, competitive enough SPEC with long-term quality and reliability, covering most of the potential industrial applications.

Product data

General information		CE mark	
Beam angle of light source	60 °	ENEC mark	-
Lamp colour code	840 neutral white	Warranty period	3 years
Light source replaceable	No	Constant light output	Programmable
Number of gear units	2 units	Number of products on MCB (16 A type B)	8
Driver/power unit/transformer	PSU [Power supply unit]	EU RoHS compliant	Yes
Driver included	Yes	Light source engine type	LED
Optic type	60 [Beam angle 60°]	Operating and electrical	
Optical cover/lens type	Without cover	Input Voltage	220 to 240 V
Luminaire light beam spread	60°	Input frequency	50 or 60 Hz
Control interface	DALI	Initial CLO power consumption	207 W
Connection	No [-]	Average CLO power consumption	207 W
Cable	Cable 0.3 m without plug	Inrush current	60 A
Protection class IEC	Safety class I (I)	Inrush time	0.6 ms
Glow-wire test	750/5 [Temperature 750 °C, duration 5 s]	Power factor (min.)	0.95
Flammability mark	F [For mounting on normally flammable surfaces]		

GreenPerform Highbay G4

Controls and dimming

Dimmable	Yes
----------	-----

Mechanical and housing

Housing material	Aluminum die-cast
Reflector material	Aluminium
Optic material	Polycarbonate
Optical cover/lens material	Polycarbonate
Fixation material	Aluminium
Optical cover/lens finish	Clear
Overall height	335 mm
Overall diameter	416 mm
Colour	Grey

Approval and application

Ingress protection code	IP65 [Dust penetration-protected, jet-proof]
Mech. impact protection code	IK08 [5 J vandal-protected]

Initial performance (IEC compliant)

Initial luminous flux (system flux)	26500 lm
Luminous flux tolerance	+/-10%
Initial LED luminaire efficacy	128 lm/W
Lamp colour temperature	4000 K
Colour Rendering Index	>80

Initial input power	207 W
Power consumption tolerance	+/-10%

Over time performance (IEC compliant)

Driver failure rate at 5,000 hours	0.1 %
Median useful life L70B50	50000 h

Application conditions

Ambient temperature range	-30 to +45 °C
Maximum dimming level	5% (1 to 10 V)
Suitable for random switching	No

Product data

Full product code	911401535461
Order product name	BY698P LED265/NW PSD NB GM G2
Order code	911401535461
SAP numerator – quantity per pack	1
Numerator – packs per outer box	1
SAP material	911401535461
Net Weight (Piece)	6.499 kg

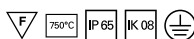

Dimensional drawing

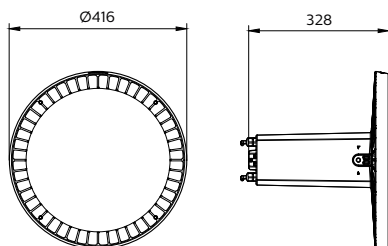

BY698P LED265/NW PSD NB GM G2

