



# GreenPerform Highbay G4

## BY698P LED265/CW PSD WB GC G2

GreenPerform Highbay G4 - 865 cool daylight - Power supply unit - Beam angle 90°

Following the success of the GreenPerform Highbay families, the GreenPerform Highbay G4 is continuously exploring a better price and performance balance. The product family offers wide product ranges, competitive enough SPEC with long-term quality and reliability, covering most of the potential industrial applications.

### Product data

General information	
Beam angle of light source	90 °
Lamp colour code	865 cool daylight
Light source replaceable	No
Number of gear units	2 units
Driver/power unit/transformer	PSU [ Power supply unit]
Driver included	Yes
Optic type	90 [ Beam angle 90°]
Optical cover/lens type	Without cover
Luminaire light beam spread	90°
Control interface	DALI
Connection	No [ -]
Cable	Cable 0.3 m without plug
Protection class IEC	Safety class I (I)
Glow-wire test	750/5 [ Temperature 750 °C, duration 5 s]
Flammability mark	F [ For mounting on normally flammable surfaces]

CE mark	CE mark
ENEC mark	-
Warranty period	3 years
Constant light output	Programmable
Number of products on MCB (16 A type B)	8
EU RoHS compliant	Yes
Light source engine type	LED

### Operating and electrical

Input Voltage	220 to 240 V
Input frequency	50 or 60 Hz
Initial CLO power consumption	207 W
Average CLO power consumption	207 W
Inrush current	60 A
Inrush time	0.6 ms
Power factor (min.)	0.95

# GreenPerform Highbay G4

## Controls and dimming

Dimmable	Yes
----------	-----

## Mechanical and housing

Housing material	Aluminum die-cast
Reflector material	Aluminium
Optic material	Polycarbonate
Optical cover/lens material	Polycarbonate
Fixation material	Aluminium
Optical cover/lens finish	Clear
Overall height	335 mm
Overall diameter	416 mm
Colour	Grey

## Approval and application

Ingress protection code	IP65 [ Dust penetration-protected, jet-proof]
Mech. impact protection code	IK08 [ 5 J vandal-protected]

## Initial performance (IEC compliant)

Initial luminous flux (system flux)	26500 lm
Luminous flux tolerance	+/-10%
Initial LED luminaire efficacy	128 lm/W
Lamp colour temperature	6500 K

Colour Rendering Index	>80
Initial input power	207 W
Power consumption tolerance	+/-10%

## Over time performance (IEC compliant)

Median useful life L70B50	50000 h
---------------------------	---------

## Application conditions

Ambient temperature range	-30 to +45 °C
Maximum dimming level	5% (1 to 10 V)
Suitable for random switching	No

## Product data

Full product code	911401533761
Order product name	BY698P LED265/CW PSD WB GC G2
Order code	911401533761
SAP numerator – quantity per pack	1
Numerator – packs per outer box	1
SAP material	911401533761
Copy Net Weight (Piece)	6.499 kg

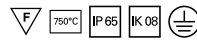

## Dimensional drawing

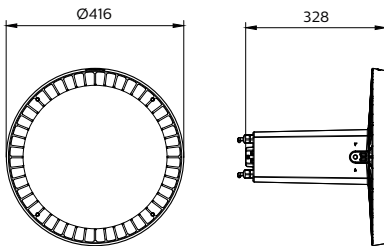

BY698P LED265/CW PSD WB GC G2

